

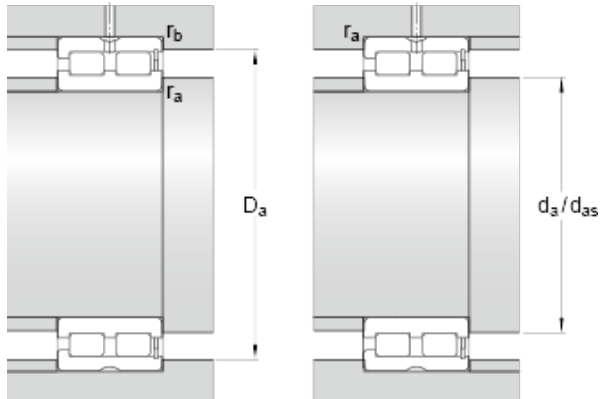

GF BEARING-SINGAPORE LTD.



320 mm x 440 mm x 118 mm skf NNCF 4964
CV Double row full complement cylindrical roller
bearings

Bearing No. NNCF 4964 CV

d	320 mm
D	440 mm
B	118 mm
d ₁	368 mm
D ₁	401 mm
b ₁	9.4 mm
K	5 mm
s max.	6 mm
r _{1,2} min.	3 mm
r _{3,4} min.	3 mm
d _a min.	336 mm
d _{as}	352 mm
D _a max.	425 mm
r _a max.	2.5 mm
r _b max.	2.5 mm
Basic dynamic load rating C	1760 kN
Basic static load rating C ₀	4050 kN
Fatigue load limit P _u	375 kN
Reference speed	600 r/min
Limiting speed	750 r/min
Calculation factor k _r	0.25
Mass bearing	55.5 kg

NNCF 4964 CV Bearing 2D drawings and 3D CAD
models