

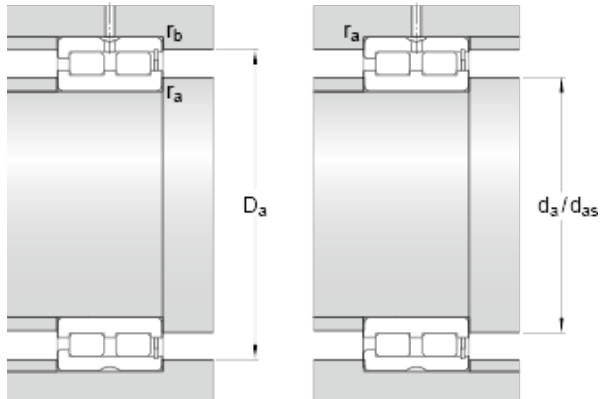

## GF BEARING-SINGAPORE LTD.



320 mm x 480 mm x 218 mm skf NNCF 5064  
CV Double row full complement cylindrical roller  
bearings

Bearing No. NNCF 5064 CV

d	320 mm
D	480 mm
B	218 mm
d <sub>1</sub>	370 mm
D <sub>1</sub>	434 mm
b <sub>1</sub>	9.4 mm
K	5 mm
s max.	9 mm
r <sub>1,2</sub> min.	4 mm
r <sub>3,4</sub> min.	4 mm
d <sub>a</sub> min.	339 mm
d <sub>as</sub>	360 mm
D <sub>a</sub> max.	462 mm
r <sub>a</sub> max.	3 mm
r <sub>b</sub> max.	3 mm
Basic dynamic load rating C	3690 kN
Basic static load rating C <sub>0</sub>	6950 kN
Fatigue load limit P <sub>u</sub>	620 kN
Reference speed	560 r/min
Limiting speed	700 r/min
Calculation factor k <sub>r</sub>	0.5
Mass bearing	135 kg

NNCF 5064 CV Bearing 2D drawings and 3D CAD  
models