

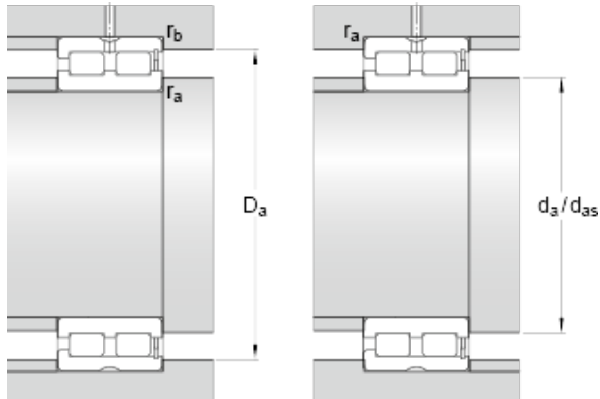

## GF BEARING-SINGAPORE LTD.



320 mm x 400 mm x 80 mm skf NNCF 4864 CV  
Double row full complement cylindrical roller bearings

Bearing No. NNCF 4864 CV

d	320 mm
D	400 mm
B	80 mm
d <sub>1</sub>	352 mm
D <sub>1</sub>	372 mm
b <sub>1</sub>	9.4 mm
K	5 mm
s max.	6 mm
r <sub>1,2</sub> min.	2.1 mm
r <sub>3,4</sub> min.	2.1 mm
d <sub>a</sub> min.	331 mm
d <sub>as</sub>	341 mm
D <sub>a</sub> max.	390 mm
r <sub>a</sub> max.	2 mm
r <sub>b</sub> max.	2 mm
Basic dynamic load rating C	897 kN
Basic static load rating C <sub>0</sub>	2280 kN
Fatigue load limit P <sub>u</sub>	208 kN
Reference speed	630 r/min
Limiting speed	800 r/min
Calculation factor k <sub>r</sub>	0.2
Mass bearing	23.5 kg

NNCF 4864 CV Bearing 2D drawings and 3D CAD models