

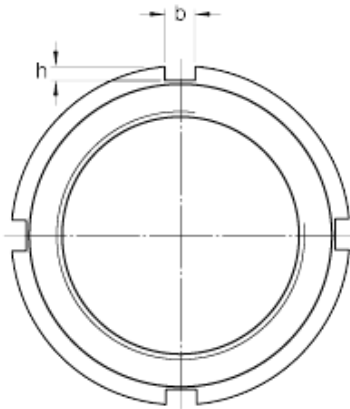

GF BEARING-SINGAPORE LTD.

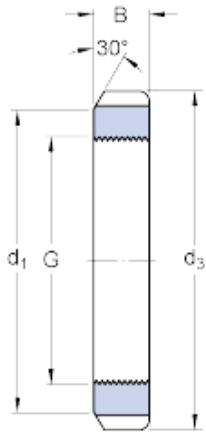

skf KML 36 Lock nuts requiring a keyway
(metric)

Bearing No. KML 36

G	M 180x3
d ₃	210 mm
B	27 mm
d ₁	200 mm
b	16 mm
h	5 mm
Axial static load carrying capacity	450 kN
Mass lock nut	1.8 kg
Associated spanner	TMFN 30-40

KML 36 Bearing 2D drawings and 3D CAD models