

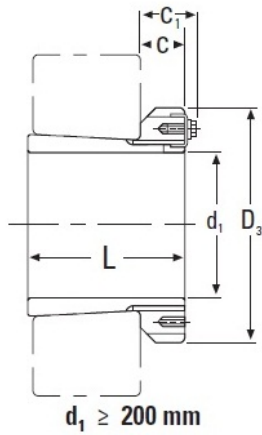

GF BEARING-SINGAPORE LTD.



timken H3276 Metric H Adapter Sleeve

Bearing No. H3276

d_1	360.00 mm
L	310.00 mm
C	60 mm
C_1^1	77.00 mm
Thread G	Tr380x5
D_3	490 mm
Weight	69.60 Kg
Locknut	HM3176
Lockwasher and Lockplates	MS 3176
Appropriate Hydraulic Nut	HMV76

H3276 Bearing 2D drawings and 3D CAD models