

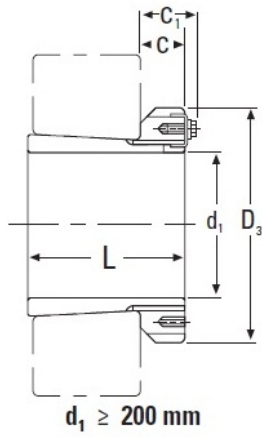

GF BEARING-SINGAPORE LTD.



timken H3296 Metric H Adapter Sleeve

Bearing No. H3296

d_1	450.00 mm
L	397.00 mm
C	75 mm
C_1^1	95.00 mm
Thread G	Tr480x5
D_3	620 mm
Weight	153 Kg
Locknut	HM3196
Lockwasher and Lockplates	MS 3196
Appropriate Hydraulic Nut	HMV96

H3296 Bearing 2D drawings and 3D CAD models